

M1 Series

Direct-drive, High-speed, Overlock / Safety Stitch Machine



Features

- The direct drive system has been adopted.
- Both the control box and the operation panel are integrated with the machine head.

M1-424SF

The maximum sewing speed of the M1 series is 7,000 sti/min.

The M1-SF type sewing machine is equipped with a 3-point sensor auto thread trimmer. This prevents the operator from accidentally cutting the cloth.

Operation panel and control box are integrated with the machine head

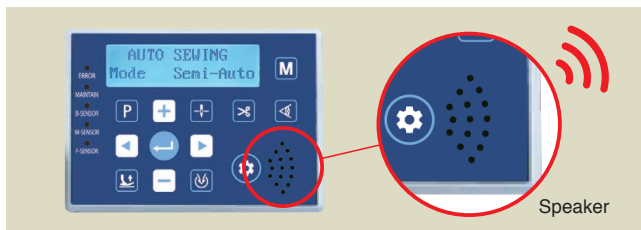

Speaker

• Voice guidance for assisting the operator

This sewing machine is provided as standard with the voice guidance.



USB Port

• Multi function USB connector

Since the USB port is provided as standard for the control box, software can be upgraded with ease.

SUBCLASS MACHINE LIST

Seams	Model No.	Materials L ▶ H	Number of needles	Number of threads	Needle gauge (mm)	Overriding width	Number of feed dog rows	Stitch length (mm)	Bottom differential feed ratio	Presser lifting amount (mm)	Needle system	Max sewing speed (sti/min)	Remarks
1-needle overlock		For runstitching in general fabric											
	M1-304NS	L~M	1	3	—	4.0	3	3.8	1:0.7~1:2	5.0	DCx27 #11	7,000	
	M1-304SF												
2-needle overlock		For runstitching in general fabric											
	M1-424NS	L~M	2	4	2.0	4.0	3	3.8	1:0.7~1:2	5.0	DCx27 #11	7,000	
	M1-424SF												
Safety stitching		For runstitching in general fabric											
	M1-535NS	L~M	2	5	3.0	5.0	3	3.8	1:0.7~1:2	5.0	DCx27 #14	7,000	
	M1-535SF												

Sewn product pictogram



UNDER SHIRTS T-SHIRTS TROUSERS ONE-PIECE SKIRT DRESS SHIRTS BLOUSE POLO SHIRTS JUMPER SPORTS WEAR SUIT COAT JEANS

OPTION DEVICE

Chain-off thread suction device (Blower fan motor type): **JINBFX5DXFZZ**
 Chain-off thread suction device (Pneumatic type): **JINBF889UT-DCFZJ-1**

SPECIFICATIONS

Model name	M1-304NS	M1-304SF	M1-424NS	M1-424SF	M1-535NS	M1-535SF
Stitch type	1-needle overlock		2-needle overlock		Safety stitching	
Max. sewing speed	7,000 sti/min*					
Stitch length	3.8 mm					
Needle gauge (mm)	-		2.0		3.0	
Overedging width (mm)	4.0				5.0	
Needle bar stroke	23.0 mm					
Needle	DCX27 #11				DCX27 #14	
Max. lift of the presser foot	5.0 mm					
Sensor control / Tape cutter / Auto-lifter	-	provided	-	provided	-	provided

*sti/min is the abbreviation for "stitches per minute"

WHEN YOU PLACE ORDERS

Please note when placing orders, that the model name should be written as follows:

Stitch type	U.S.A	Code
1-needle, 3 thread overlock	504	3
2-needle, 4 thread overlock	514	4
2-needle, 5 thread safety stitch	516	5

M 1 -

Needle gauge (mm)	Overedging width (mm)	Feed dog	Code
-	4.0	3-row	04
2.0	4.0	3-row	24
3.0	5.0	3-row	35

Chain-off thread trimmer / auto lifter	Control box	Code
Not provided	without Chain-off thread trimmer	NS
Solenoid type	with Chain-off thread trimmer	SF

JUKI INDIA PVT. LTD.

GROUND AND 1ST FLOOR, NO.1090/1, 18TH CROSS ROAD, 3RD SECTOR,
 HSR LAYOUT BANGALORE-560 102, KARNATAKA STATE, INDIA
 PHONE: (91) 80-4251-1900 FAX: (91) 80-4251-1999
<http://jukiindia.com>

* Specifications and appearance are subject to change without prior notice for improvement.
 * Read the instruction manual before putting the machine into service to ensure safety.

JULY, 2020 Printed (TN)